

# Starry Night

[www.2DKits.com](http://www.2DKits.com)[www.build-a-blinkie.org](http://www.build-a-blinkie.org)

## Parts List

Printed circuit  
board (PCB)

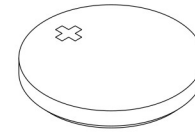

2032 battery

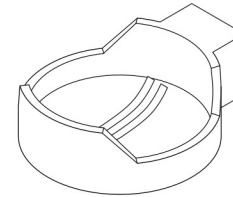

Battery holder

Tie tack clasp  
(packaged together)

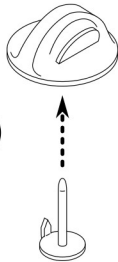

Tie tack

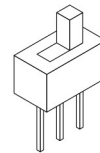

Switch

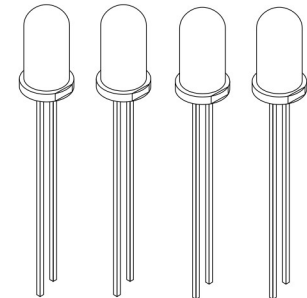

LED (4x)

Need help? Please raise your hand.

# How To Solder

Solder flows and bonds to *hot* metal. The iron is used to melt the solder *and* heat the parts so the solder sticks.

With a little practice, a good a solder joint should take about 8 to 10 seconds. The iron does not move during this time.

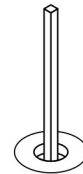
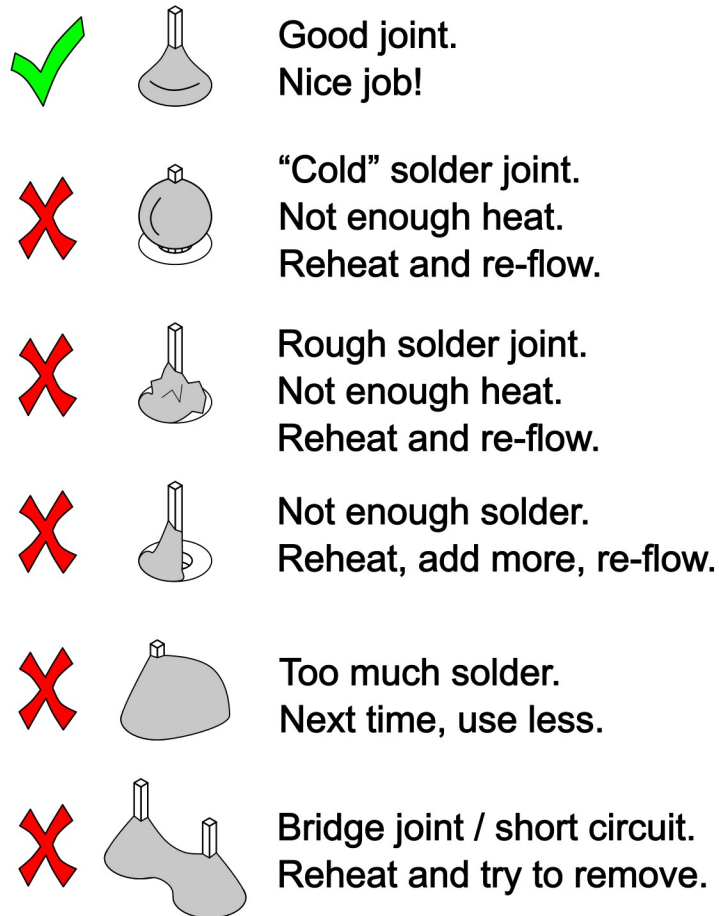

Insert and align part.

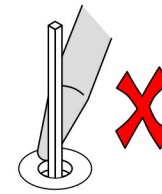
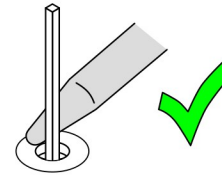

Touch iron to part  
wire *and* PCB pad.

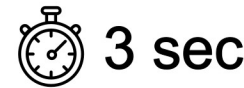
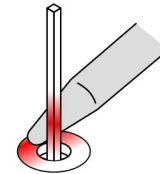

3 sec

Heat wire and pad.

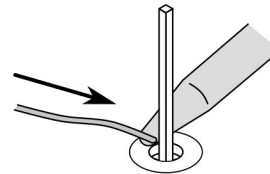

Melt about 1/2 inch  
of solder into joint.

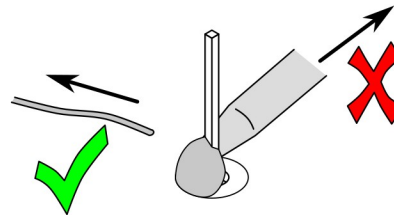

Remove solder.  
DO NOT remove iron.

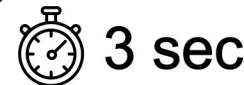
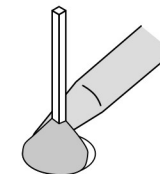

3 sec

Continue to heat solder and  
parts. When everything gets  
hot enough, the solder often  
"pops" and flows into place.

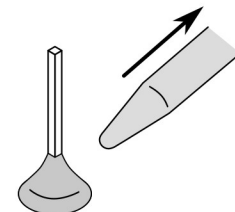

When solder flows across  
parts, remove iron. The solder  
will cool and harden in seconds.







